

## Hotel Albuquerque

sleeping rooms:	188
number of suites:	20
meeting rooms:	14
total square feet of convention space:	41,000 sq ft
maximum meeting capacity:	1,400
banquet facility:	yes
high speed	
wireless internet:	yes
voice messaging:	yes
on-site audio/visual:	yes
handicap accessible:	yes
restaurants:	2
on-site car rental:	yes
complimentary parking:	yes
restaurants:	yes
bar:	2
swimming pool:	yes
jacuzzi and salon:	yes
smoke free rooms:	yes
laundry/valet:	yes
room service:	yes
Outdoor event space	21,000 sq ft
Chapel	seats 156 people



## HOTEL ALBUQUERQUE at old town

800 Rio Grande Blvd. NW  
Albuquerque, NM 87104  
tel. 505.843.6300  
toll-free 800.237.2133  
fax. 505.842.8426  
www.buynewmexico.com

Nestled in the heart of Albuquerque's historical center, **Hotel Albuquerque at Old Town** is a unique blend of Native American, Mexican, Spanish and Western cultural traditions. The result is a magical experience that allows guests of the hotel to discover more than 400 years of history and native New Mexican heritage. Adjacent to the hotel is Albuquerque's historic Old Town, featuring over 200 shops, restaurants and art galleries.

After a day of adventures, taste some of the State's most authentic cuisine while sipping margaritas or an icy sangria. Rejuvenate in the hotel's pool area and outdoor portals. Whatever the occasion or event, **Hotel Albuquerque at Old Town** offers warm and captivating accommodations that invite guests to truly discover the Land of Enchantment.

- Cristobal's, specializing in the cuisine de Albuquerque is a frontier fusion of great American West entrees imbedded with flavors of Old Mexico—served with New Mexican flair.

- For breakfast and lunch, Visit Café Plazuela and Cantina, a more casual New Mexican restaurant featuring savory enchiladas, chili cheeseburgers, sandwiches and specialty salads. Guests are surrounded by large handpainted windows, arched doors, and a stenciled turquoise blue cove ceiling.
- Q-Bar, a 5000 square foot multi-venue bar has quickly become Albuquerque's most sophisticated and ultra-chic hot spot! Containing a piano lounge, wine, media and billiards rooms, Q-Bar provides a series of intimate spaces for conversation and a variety of entertainment options. Light jazz and piano entertainment is featured Tuesday's through Saturday's from 6:00 pm to midnight. Open daily at 4:00 PM. Available for private parties.
- Pamper yourself from head to toe in Joseph's Salon.
- Just steps away from the hotel are the Albuquerque Museum, the New Mexico Museum of Natural History, the Explora Science Center and the Albuquerque Aquarium and Botanic Garden.



- Located approximately five miles from the downtown Convention Center, **Hotel Albuquerque at Old Town** features a 14,000 square foot state-of-the-art Grand Ballroom, 27,000 square feet of exhibit, meeting and pre-function space and 21,000 square feet of outdoor event space. Experience **Hotel Albuquerque at Old Town**, the premier convention hotel in New Mexico.



# BUILDING FACILITIES & ROOM CAPACITIES

ROOM	DIMENSIONS						CAPABILITIES					
	SQ. FT.	SIZE	CEILING	THEATRE	CLASSROOM	U-SHAPE	HOLLOW SQUARE	CONFERENCE	RECEPTION	BANQUET	W/DANCE	
<b>ALVARADO GRAND</b>	<b>14,000</b>	<b>156 X 90</b>	<b>22'</b>	<b>1,360</b>	<b>960</b>	<b>N/A</b>	<b>N/A</b>	<b>N/A</b>	<b>1,800</b>	<b>1,100</b>	<b>950</b>	
A	1,240	31 X 40	22'	100	60	30	40	40	120	80	N/A	
B	1,181	30 X 40	22'	100	60	30	40	40	100	80	N/A	
C	1,137	28 X 40	22'	100	60	30	40	40	100	80	N/A	
D	3,442	38 X 90.5	22'	336	256	80	90	N/A	400	280	200	
E	3,442	38 X 90.5	22'	336	256	80	90	N/A	400	280	200	
F	1,240	31 X 40	22'	100	60	30	40	40	120	80	N/A	
G	1,181	30 X 40	22'	100	60	30	40	40	100	80	N/A	
H	1,137	28 X 40	22'	100	60	30	40	40	100	80	N/A	
ABCD or EFGH	7,000	78 X 90.5	22'	680	480	100	130	N/A	900	550	400	
FRANCISCAN	3,796	52 X 73	12'	350	225	80	90	N/A	400	330	230	
POTTERS	1,080	27 X 40	10'	100	60	30	40	40	100	80	N/A	
WEAVERS	1,080	27 X 40	10'	100	60	30	40	40	100	80	N/A	
TURQUOISE	1,080	27 X 40	10'	100	60	30	40	40	100	80	N/A	
FIREPLACE	870	33 X 27	12'	75	40	20	30	30	75	60	N/A	
CHAPEL	2496	29 X 58	28'	156	N/A	N/A	N/A	N/A	N/A	N/A	N/A	
NORTH PORTAL	976	16 X 61	10'	N/A	N/A	N/A	N/A	30	50	40	N/A	
SOUTH PORTAL	1170	15 X 78	10'	N/A	N/A	N/A	N/A	40	100	70	40	
EAST PORTAL	1590	15X106	10'	N/A	N/A	N/A	N/A	40	125	100	60	
PAVILION	1380	23x60	N/A	160	120	60	70	70	200	150	100	
ROSEMARY GARDEN	4048	44x92	N/A	300	200	80	90	N/A	400	300	200	
JUNIPER GARDEN	5060	55x92	N/A	375	250	80	90	N/A	450	370	300	

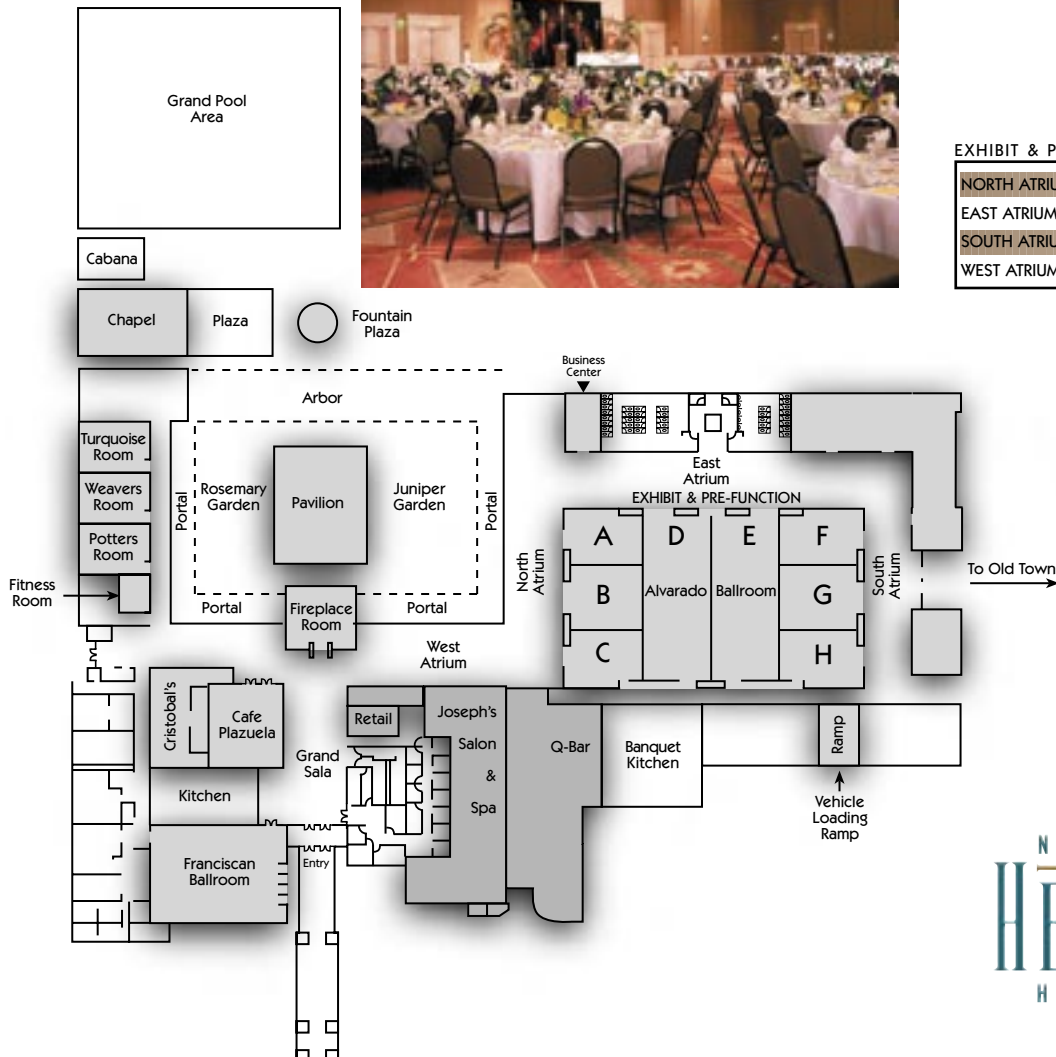

**EXHIBIT & PRE-FUNCTION SPACE**

NORTH ATRIUM	4,740 sq ft
EAST ATRIUM	3,660 sq ft
SOUTH ATRIUM	2976 sq ft
WEST ATRIUM	2048 sq ft